

**Yamato**

# VF2500-8

2, 3 NEEDLE FLAT BED INTERLOCK STITCH MACHINE  
WITH ACTIVE THREAD CONTROL

**Your Best Solution in  
Meeting Wide Variety of  
Sewing Condition.**



ISO9001:2008  
JQA-QM6412

**Yamato**

# VF2500-8

2, 3 NEEDLE FLAT BED INTERLOCK STITCH MACHINE  
WITH ACTIVE THREAD CONTROL

■ Numbering on Model:

## VF2403-140M-8/EC

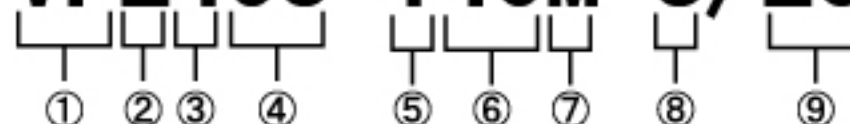

- ① Symbol of Series
- ② Class No.
- ③ Number of Needle : 4 = 2 needle, 5 = 3 needle
- ④ Submodel by Application
- ⑤ Top Cover Thread Mechanism : 1 = with Top Cover Thread Mechanism
- ⑥ Needle Distance : 32 = 3.2mm 40=4.0mm 48=4.8mm 56=5.6mm
- ⑦ Shape of Stitch Tongue on Stitch Plate
- ⑧ For elastic materials
- ⑨ Device(s)

■ Specifications

MODEL	SEAM									
<b>VF2500-8</b>		UY128GAS 3	5	5.6	1.4-3.6		10.7-12			
<b>VF2403-8</b>		UY128GAS 2	4	4.0	1.4-3.6					
<b>VF2429-8</b> <b>VF2439-8</b>		UY128GAS 2	4	4.0 5.6	1.4-3.6					
<b>VF2459-8</b>		UY128GAS 2	4	3.2	1.4-3.6					

Specification and appearance on this catalogue are subject to change without notice. For correct handling of products described on this catalog, please read instructions carefully before operation.

**YAMATO SEWING MACHINE MFG. CO., LTD.**  
http://www.yamato-sewing.com

**HEAD OFFICE**  
4-12, 4-CHOME, NISHI-TENMA, KITA-KU, OSAKA, 530-0047, JAPAN  
TEL:+81-6-6384-5621 / FAX:+81-6-6384-7185 / E-mail: export-dept@yamato-sewing.com

YAMATO U.S.A. INC. TEL:+1-803-548-0334/FAX:+1-803-548-0405  
YAMATO EUROPE GmbH. TEL:+49-40-355347-0/FAX:+49-40-354371/E-mail:sales@yamato.de  
YAMATO (HONG KONG) CO., LTD. TEL:+852-2721-0251/FAX:+852-2723-0444/E-mail:yamato@yamato-sewing.com.hk  
香港(香港)有限公司 东莞代表处 TEL:+86-768-86231363/FAX:+86-768-86231362  
大和縫紉機(宁波)有限公司 TEL:+86-574-86800518,86800558/FAX:+86-574-86800555/E-mail:marketing@yamato-china.com  
大和縫紉機製造株式会社 青島事務所 TEL:+86-532-85783175/FAX:+86-532-85783172  
大和縫紉機製造株式会社 上海事務所 TEL:+86-21-64400017,64400019/FAX:+86-21-64400021  
YAMATO SINGAPORE PTE LTD. TEL:+65-6287-1955/FAX:+65-6287-1028/E-mail:sales@yamato-sewing.com.sg  
YAMATO SINGAPORE PTE LTD, INDIA LIAISON OFFICE, TIRUPUR MAIN BRANCH TEL:+91-421-4333701/FAX:+91-421-4333702/E-mail:yamato-sewing@airtelbroadband.in  
YAMATO SINGAPORE PTE LTD, INDIA LIAISON OFFICE, DELHI BRANCH TEL:+91-11-41603280/FAX:+91-11-41603281  
YAMATO SINGAPORE PTE LTD, CUSTOMER SERVICE CORRESPONDENT IN JAKARTA, INDONESIA Fax : +62-21-781-8727  
YAMATO MEXICO OFFICE TEL:+52-55-5764-9090/FAX:+52-55-5578-1470  
THE RESIDENT REPRESENTATIVE OFFICE OF YAMATO SEWING MACHINE MFG. CO., LTD IN HO CHI MINH CITY TEL:+84-8-62966057/FAX:+84-8-38113384

## YAMATO VF2500-8

## 2, 3 NEEDLE FLAT BED INTERLOCK STITCH MACHINE WITH ACTIVE THREAD CONTROL

If you are looking at further flexibility for the recent frequent and big change in sewing condition, YAMATO VG-8 is the right machine. YAMATO VG-8's "Active Thread Control(PAT.P)" performs epoch-making soft and elastic seams suitable for lady's intimate garments with "microfiber", which is lightweight, soft and stretchable. It is also applicable for neatly tightened seams, ideal for the outer knitwear by the simple and "visible" adjustment. Besides, "Non-stain(PAT.P)" technology is introduced to minimize oil stains on your products.

YAMATO VG-8 helps you winning further confident from your clients with your improved quality and quicker response.

### ■ Active Thread Control(PAT.P)

Unlike the conventional way of thread control, which mainly use tension (resistance) on each thread, YAMATO "Active Thread Control" takes in and draws back thread when it is required, and well-balanced seams with minimum necessary tension(resistance) for thread regulation. Besides, wide variety of seams, from soft and elastic seams to standard seams, can be performed by the simple and "visible" adjustment, not by the "fuzzy" adjustment using thread tension devices.

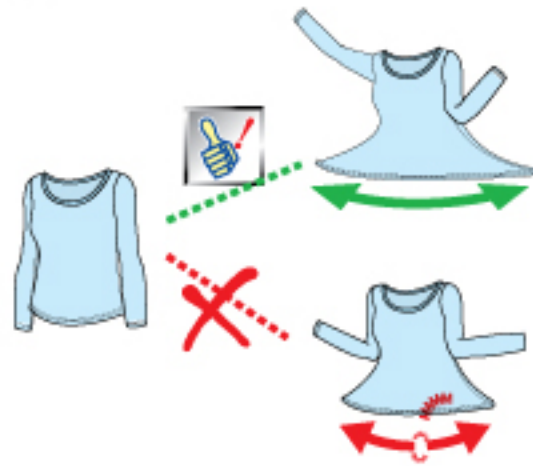

VF2500-8

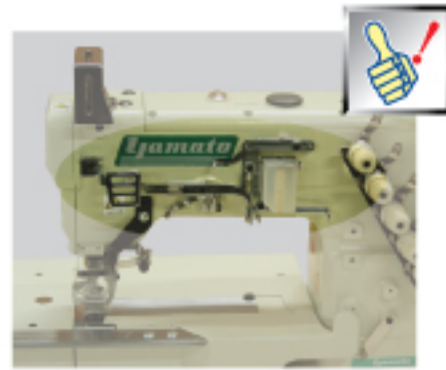

### ■ "Non-stain" (PAT.P)

While giving enough lubrication for the internal driving mechanism, Yamato exclusive sealing system prevents the oil from coming to the sewing area through moving parts. This feature minimizes the risk of oil stain, one of the most frequent causes of defects.

*Saving -"Non-stain" increases productivity.*  
"Non-stain" finish minimizes your loss, such as downtime and extra cost caused by spot removing operations.

*Good performance and long life- durable machines*  
Yamato "Non-stain" technology will not sacrifice the performance and the durability of machines, but keep the machine running smoothly at high speed for long life.

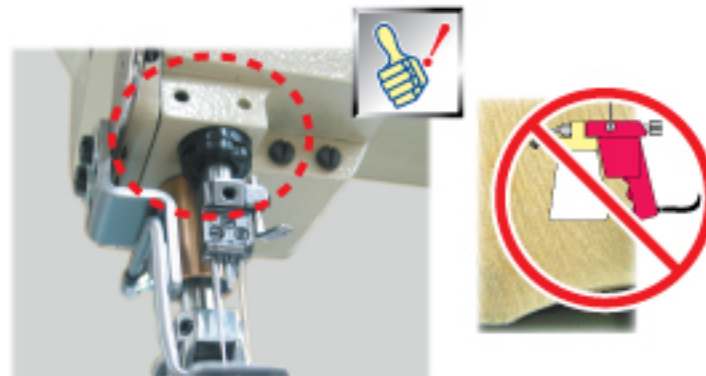

## VF2500-8 3 Needle 5 Thread Flat Bed Interlock Stitch Machine

New type of Flat Bed for easy handling  
Newly designed bed shape and various accessories make the machine applicable for various operations such as decorative seams, covering, hemming etc.

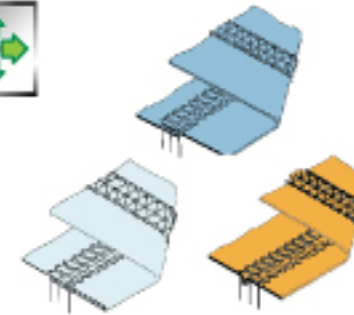
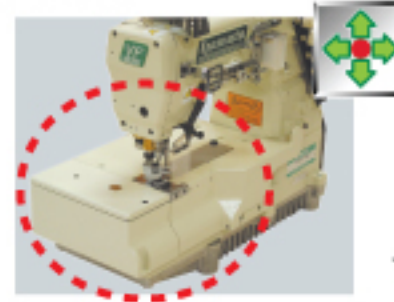

Tunnel free finish for better appearance and comfort-to-wear garments.

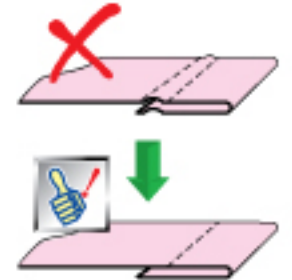

## VF2403-8 2 Needle 4 Thread Flat Bed Interlock Stitch Machine for Binding

Suitable for the neck binding of various kinds of knitwear with microfiber.



## VF2429-8 2 Needle 4 Thread Flat Bed Interlock Stitch Machine, for Attaching Elastic Tape and Waist Band, with Right Hand Fabric Trimmer

26 x 20 different tape tensions are programmable to meet various styles and sizes of garments



VF2429-8

## VF2439-8 2 Needle 4 Thread Flat Bed Interlock Stitch Machine for Attaching Lace, with Right Hand Fabric Trimmer and Mechanical Elastic Metering Device

Best solution for "seam burst" on turning curves with the fabric trimmer, which is installed just in front of binder.

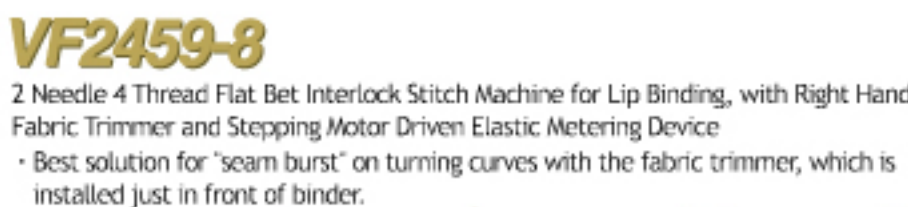

## VF2459-8 2 Needle 4 Thread Flat Bed Interlock Stitch Machine for Lip Binding, with Right Hand Fabric Trimmer and Stepping Motor Driven Elastic Metering Device

Best solution for "seam burst" on turning curves with the fabric trimmer, which is installed just in front of binder.

