

LS-8121

洗标机

Washing label seaming machine

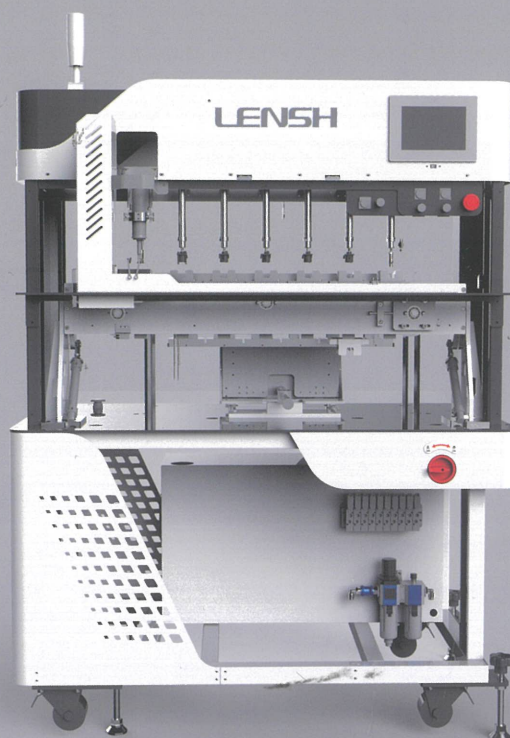

应用范围 | Application

适用于服装、箱包多层商标的叠合固定

It is suitable for the overlapping and fixing of multi-layer logos of clothing and bags



规格范围 | Specification range

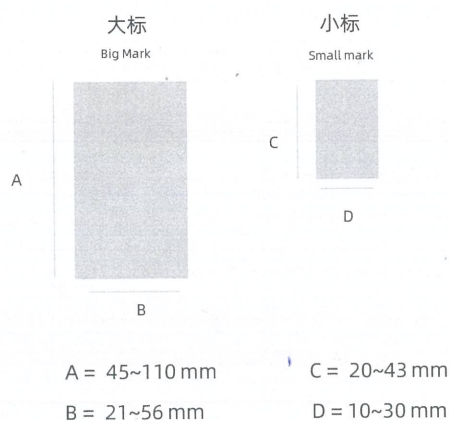

大标与小标组合方式 Combination of large and small standard

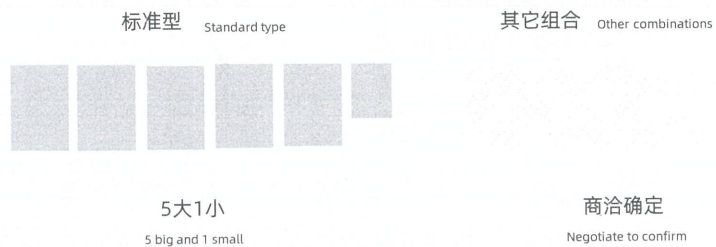

应用工艺 | Application process

应对需求，突破常规设计

Response to demand, set two-way function, can be switched at will

阻尼式料仓调节

Damped silo adjustment

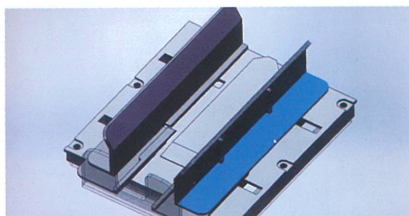

无需调节螺丝 快速设定

No adjustment screws required Quick setting

远程数据采集系统（选配）

Remote data collection system (optional)

LSSX



故障率数据	Failure rate data
产能数据	Capacity data
使用率数据	Usage data

效率分析 | Efficiency analysis

~ 600 %

Before ~ 21s



人工叠合缝订 效率低

Manual overlapping stitching is inefficient

After ~ 3.5s



自动上料叠合固定 高效率高品质

Automatic feeding stacking and fixing High efficiency and high quality

LENSH

专注服装自动化
Focus on knitting automation

技术参数 | Technical parameters

型号	Model	LS-8121
电压	Voltage	220V 50~60Hz Single 单相
功率	Power	1 KW
气压	Air Pressure	0.5-0.6 MPa
外形尺寸	Dimensions	1200*650*1720 MM
装箱尺寸	Packing size	1300*820*1840 MM
净重	Net weight	275 KG
毛重	Gross weight	395 KG

*以上型号仅供参考，详细情况请咨询。
The above models are for reference only, please inquire for details.

*为了改良，产品规格若有变更，恕不另行通知。为安全起见，使用之前，请仔细阅读使用手册。
For improvement, product specifications are subject to change without notice. For safety reasons, read the manual carefully before use.



浙江凌志智能科技有限公司
ZHEJIANG LENSH INTELLIGENT TECHNOLOGY CO.,LTD.

地址：宁波市海曙区光文路500号 电话(TEL): 0574-8742 3969 0574-8388 5719
Address: No 500 RD Guangwen District Haishu Ningbo Zhejiang, China E-mail: wuhanqiao66@163.com web: www.lensh.net